

Pin Clamp Cylinder/Compact Type

C(L)KQG32-X3036

032

Replacement Parts

Guide Pin Part Nos.

CKQG32X - 075 R

● Guide pin diameter

* Refer to Table 1 below.

● Guide pin shape

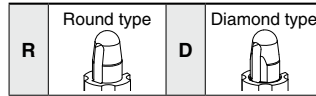

Table 1. Guide Pin Diameter

Symbol	075	076	077	078	079	080	095	096	097	098	099	100	105	106	107	108	109	110	115	116	117	118	119	120
Guide pin diameter [mm]	7.5	7.6	7.7	7.8	7.9	8.0	9.5	9.6	9.7	9.8	9.9	10.0	10.5	10.6	10.7	10.8	10.9	11.0	11.5	11.6	11.7	11.8	11.9	12.0
Applicable hole diameter of workpiece [mm]	For ø8						For ø10						For ø11						For ø12					
Guide pin shape	Round type						Round type/Diamond type																	

Symbol	125	126	127	128	129	130	135	136	137	138	139	140	145	146	147	148	149	150	155	156	157	158	159	160
Guide pin diameter [mm]	12.5	12.6	12.7	12.8	12.9	13.0	13.5	13.6	13.7	13.8	13.9	14.0	14.5	14.6	14.7	14.8	14.9	15.0	15.5	15.6	15.7	15.8	15.9	16.0
Applicable hole diameter of workpiece [mm]	For ø13						For ø14						For ø15						For ø16					
Guide pin shape	Round type/Diamond type																							

Symbol	175	176	177	178	179	180	195	196	197	198	199	200
Guide pin diameter [mm]	17.5	17.6	17.7	17.8	17.9	18.0	19.5	19.6	19.7	19.8	19.9	20.0
Applicable hole diameter of workpiece [mm]	For ø18						For ø20					
Guide pin shape	Round type/Diamond type											

Clamp Arm Assembly Part Nos.

Applicable hole diameter of workpiece	Part no.
For ø8	CKQ32-54-117ZV-R
For ø10 and ø11	CKQ32-54-118ZV-R
For ø12 and ø13	CKQ32-54-119ZV-R
For ø14 and ø15	CKQ32-54-120ZV-R
For ø16	CKQ32-54-121ZV-R
For ø18 and ø20	CKQ32-54-122ZV-R

* The clamp arm includes a basic internal retaining ring.

Option

Shim

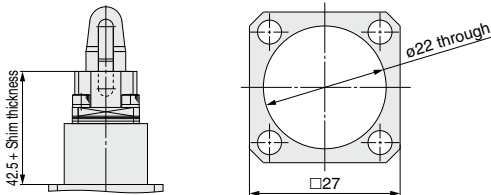

Description	Part no.	Note
Shim A	CKQ32-36A746MN	Plate thickness 1 [mm]
Shim B	CKQ32-36B746MN	Plate thickness 0.5 [mm]

- Shims can be mounted up to 3 mm.
- For auto switches (excludes the M9□V), when the total thickness of shims and a workpiece is over 2 mm, the auto switch may not be adjusted to the most sensitive position.